

VS 100 Guide rail
VS 100 Wire



- Ensure that the awning is fixed to a sufficiently secure base. If needed - contact the façade- or window supplier for specific information.
- Check that the screen fits where supposed to be installed.
- Opening windows and doors may limit the possibility for installing screens.
- The motor and any control equipment must be installed by an authorised electrician.

VS 100 Guide rail - installing wall brackets and cassette

Use the drilled holes in the guide rail to mark the hole positions on the mounting surface (wall A or niche B) and drill, if necessary, to correct diameter.

Screw the guide rails to the surface with suitable screws and check so that the profiles are vertical, parallel and on the same level.

Before continuing, check that the rails are installed with the same c-c as the legs of the cassette gables. Adjust if needed.

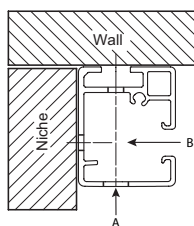

Left guide rail, top view

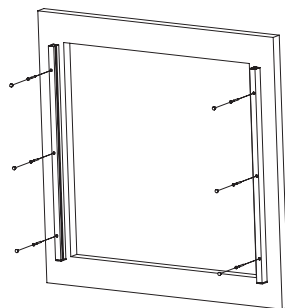

Lift the cassette on top of the guide rails, make sure not to damage the motor cable.

Carefully assemble the legs of the cassette gables into the guide rails, make sure the cassette gables rest on the guide rails and are levelled.

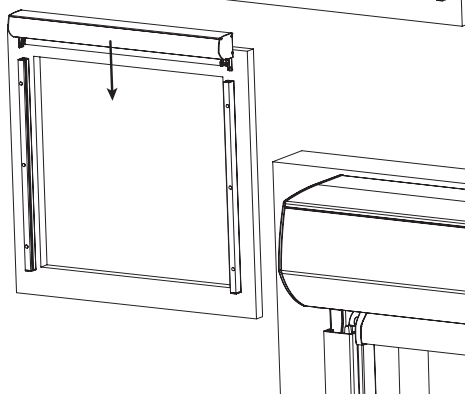

Installing extension brackets (optional)

Measure the positions for the extension brackets - then screw these to the wall with proper screws.

Pre-assemble the flange nuts on the T-slotted bolts. Slide these into the guide rails (2 pcs/bracket).

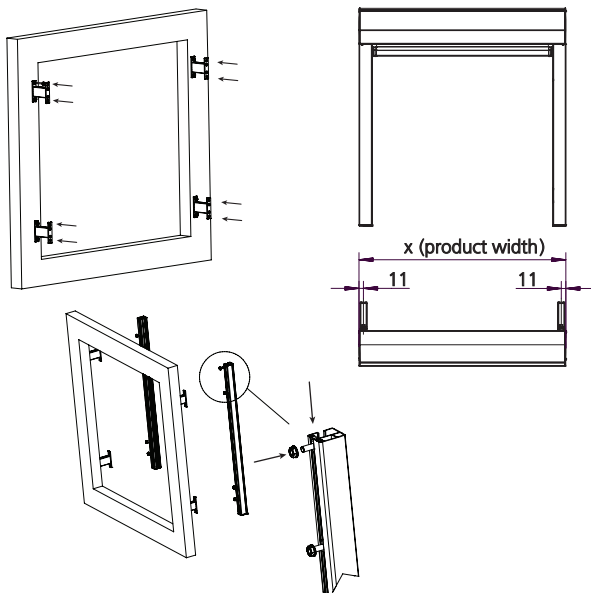

Screw the guide rails to the extension brackets

Make sure the guide rails are vertical, parallel and levelled.

Assemble the cassette according to the manual.

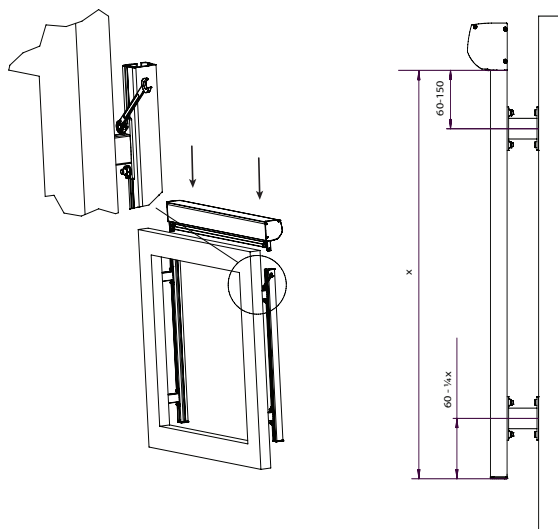

VS 100 Guide rail - interior tape operation

Drill a hole through the wall/window as illustration to the right.

Pull the tape through the drilled hole - assemble the cassette as described

Pull the tape through the tape lock and the tassel

Screw the tape lock to the wall straight outside the hole - make sure the tape runs freely through the tape lock when operating.

Finish the installation by carefully lower the front profile to the desired end position - move the tassel to the top and make a knot directly under the tassel.

Remove any extra tape.

Operate the screen up and down a few times to make sure it operates smoothly - adjust if needed.

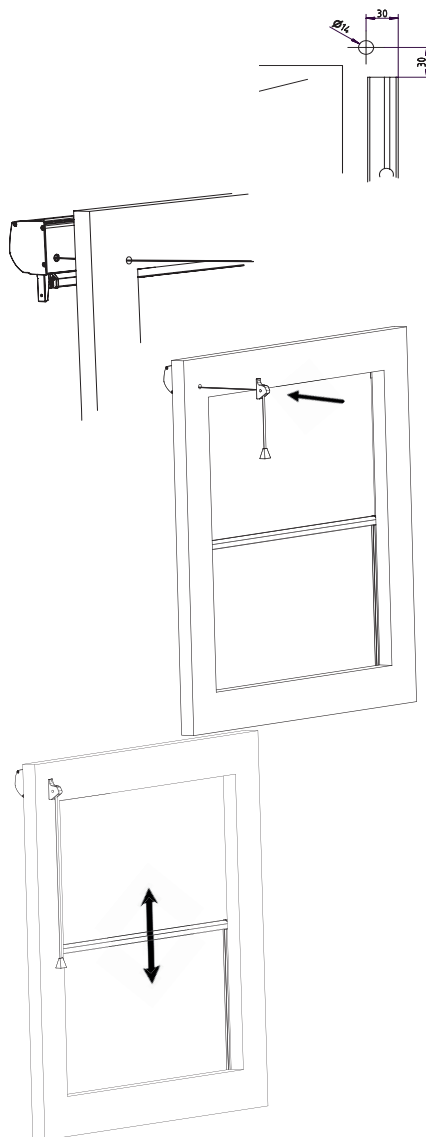

VS 100 Guide rail - installing cassette support (optional)

Screw the cassette support (optional) to the wall.

Assemble the upper slot on the back side of the cassette on to the cassette.

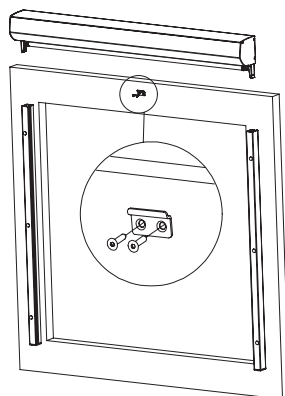
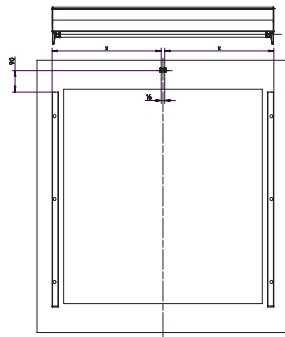

Connect the screen to the electricity.

Set the end limits - run the screen up and down to make sure the screen is operating properly.

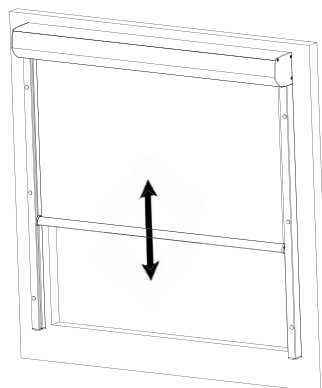

VS 100 Wire - Assembling wall brackets and cassette

Center the cassette above the window and mark the left and right sides.

Position the wall brackets 3-4 mm in from the ends of the cassette - make sure all wall brackets are levelled.

Screw the wall brackets to the wall/window - use correct screws for the type of material. Pre-drill holes if necessary.

The back of the cassette is to be hanged onto the brackets at an angle - level the cassette into the brackets and fix it with the screws under each bracket.

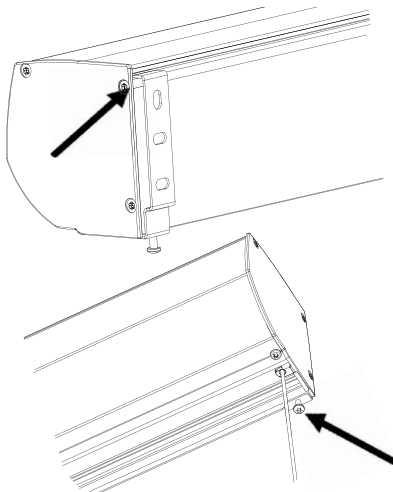
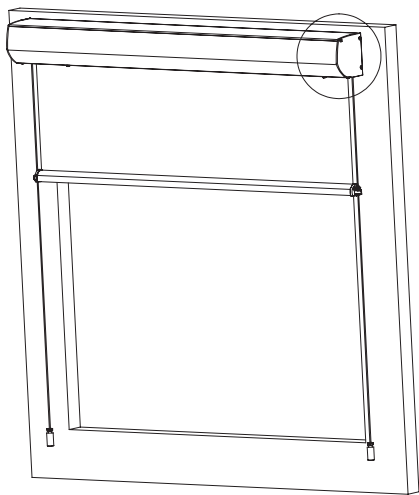
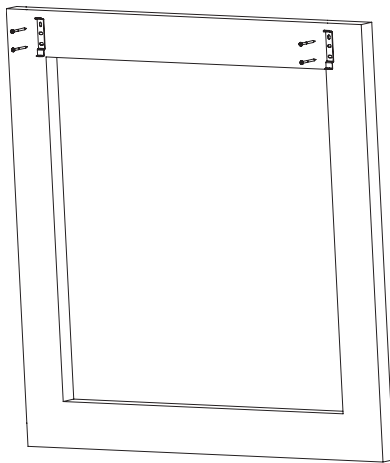

VS 100 Wire - Assembling the tensioning brackets

Roll down the fabric to the desired bottom position - assemble the tensioning brackets to the wall/window at the desired position. (The brackets are to be installed 16 mm in from each side of the cassette.)

Assemble the wire tensioners and thread the wire through the centre holes. Screw the locking ring to the wire - slide the wire tensioners into the tensioning brackets - fix the tensioners to the tensioning brackets.

Make sure the wire is pre-tensioned.

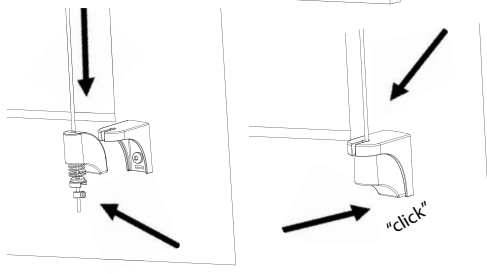
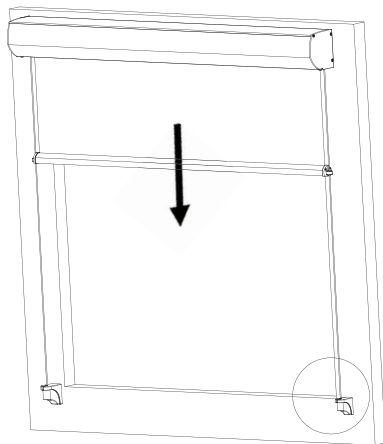

Connect the screen to the electricity.

Set the end limits - run the screen up and down to make sure the screen is operating properly

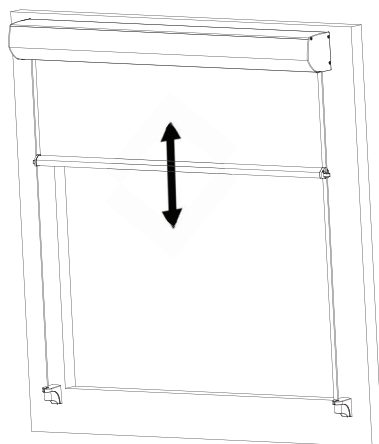

VS 100 Wire -Interior tape operation

Center the cassette above the window.
Mark the bottom, left and right side.

Install the wall brackets 3-4mm in from each side of the cassette. Make sure the brackets are levelled.

Screw the wall brackets to the wall/window - use correct screws for the type of material. Pre-drill holes if necessary.

Drill the 14mm hole through the wall/window as described.

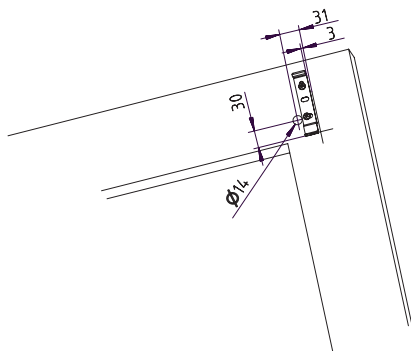
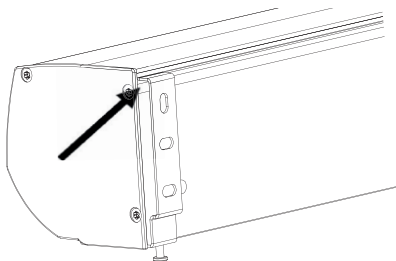
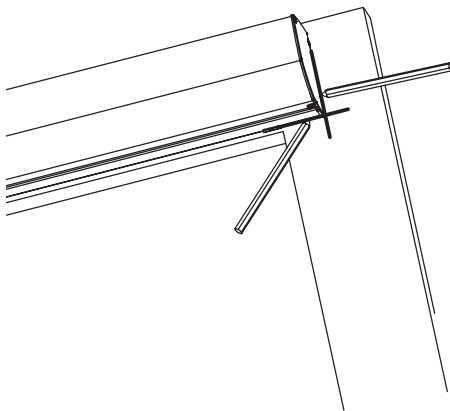

VS 100 Wire - Interior tape operation

Finish the installation by carefully lower the front profile to the desired end position - move the tassel to the top and make a knot directly under the tassel.

Remove any extra tape.

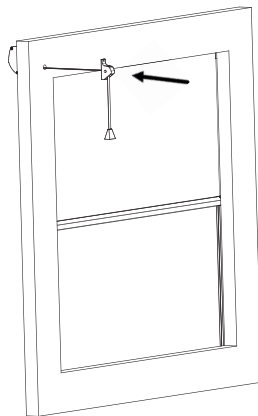
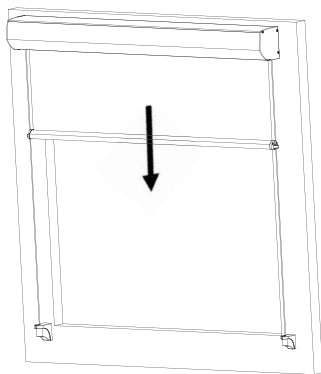

Operate the screen up and down a few times to make sure it operates smoothly - adjust if needed.

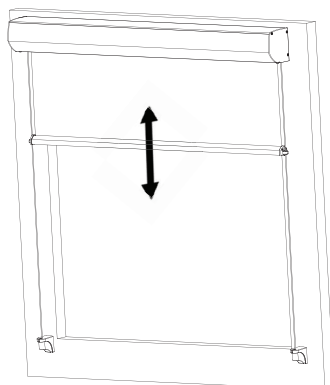

Maintenance

Maintenance:

The frame and the fabric are subjected to dirt and pollution and should be cleaned at least once a year in order to retain their high finish. This is particularly important in more exposed installations, e.g. environments near the sea. Use a soft cloth, tepid water and a mild cleaner. Do not use a high-pressure washer as it can damage the awning fabric and any electrical equipment, etc. For a detailed description of cleaning the fabric, please refer to its usage instructions.

Changing the fabric:

Before changing the awning fabric it is recommended to contact the company from which the awning was purchased to arrange an inspection of the frame. This company can provide more information about changing the fabric and also provides advice in case some other components may need to be replaced in order for the awning to maintain its finish and function.

Warning!

Always allow a professional to perform work that requires the cassette to be opened. The cassette needs to be opened when replacing the motor and/or fabric. When the cassette is opened, other parts can be damaged or out of position, and moving parts become accessible.

Any work with the motor requires proper authorization. This should therefore always be carried out by a professional.

The original document may not be altered in text or version without the consent of Hunter Douglas Scandinavia